

ਦਫਤਰ : ਕਾਰਜਕਾਰੀ ਇੰਜੀਨੀਅਰ, ਪ੍ਰਾਂਤਕ ਮੰਡਲ ਲੋਕ ਨਿਰਮਾਣ ਵਿਭਾਗ ਭਵਨ ਤੇ ਮਾਰਗ ਸ਼ਾਖਾ, ਮਾਨਸਾ।

ਟੈਲੀਫੋਨ/ਫੈਕਸ ਨੰ: 01652-232119

E Mail ID :- xen.mansa@gmail.com

ਪੱਤਰ ਨੰਬਰ632

ਮਿਤੀ.....03/06/2021

ਵੱਲ,

ਪ੍ਰਿੰਸੀਪਲ,

ਡੀ.ਏ.ਵੀ. ਪਬਲਿਕ ਸਕੂਲ,

ਖਹਿਰਾ ਖੁਰਦ (ਮਾਨਸਾ)।



ਵਿਸ਼ਾ:- ਬਿਲਡਿੰਗ ਸੇਫਟੀ ਸਰਟੀਫਿਕੇਟ ਜਾਰੀ ਕਰਨ ਸਬੰਧੀ। (ਸਾਲ 2021-22)

ਹਵਾਲਾ:- ਆਪ ਦਾ ਪੱਤਰ ਨੰ. DAV/2021-22/048 ਮਿਤੀ 25/03/2021

ਤੁਹਾਡੇ ਕਾਲਜ ਦੀ ਬਿਲਡਿੰਗ ਦਾ ਇੰਜੀਨੀਅਰ ਇੰਚਾਰਜ ਵੱਲੋਂ ਨਿਰੀਖਣ ਕੀਤਾ ਗਿਆ। ਨਿਰੀਖਣ ਦੌਰਾਨ ਪਾਇਆ ਗਿਆ ਕਿ ਕਾਲਜ ਦੀ ਬਿਲਡਿੰਗ ਸੇਫ ਹੈ। ਇਸ ਲਈ ਉਪ ਮੰਡਲ ਇੰਜੀਨੀਅਰ ਵੱਲੋਂ ਕੀਤੀ ਸਿਫਾਰਸ਼ ਨੂੰ ਮੁੱਖ ਰੱਖਦੇ ਹੋਏ 31/03/2022 ਤੱਕ ਬਿਲਡਿੰਗ ਸੇਫਟੀ ਸਰਟੀਫਿਕੇਟ ਜਾਰੀ ਕੀਤਾ ਜਾਂਦਾ ਹੈ।

ਨੱਥੀ/ ਸਰਟੀਫਿਕੇਟ

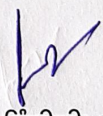
ਅਤੇ ਨਕਸ਼ਾ।



ਕਾਰਜਕਾਰੀ ਇੰਜੀਨੀਅਰ,
ਪ੍ਰਾਂਤਕ ਮੰਡਲ ਭ ਤੇ ਮ ਸ਼ਾਖਾ,
ਮਾਨਸਾ।

PERFORMA FOR THE SAFETY CERTIFICATE OF SCHOOL BUILDING

Part - I

(To be filled in by the Head of the school / institute)

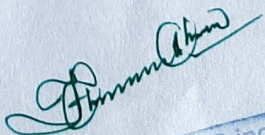
1. Name of the School D.A.V. Sr. Sec. School
2. Location Khaira Khurd, Sardulgarh
Distt. Mansa (Punjab)
3. Plot Area 87120 sq.Fts.
4. Plinth Area (Ground Floor) 16491 sq. Fts.
Plinth Area (1st Floor) 11317 sq. Fts.
5. No. of storeys Two
6. Year of construction of the building 2005 (Two thousand Five)
7. If the building has been constructed under the supervision of a qualified engineer Yes
(The following should be given)
8. Name of the Engineer with qualification Ar. Ramesh Nayol (Arch.)
9. Address of the Engineer Rorki Raod, Sardulgarh.
10. Set or structure drawing used in the construction if valid Yes
11. Name and address of the Architect with qualification Ar. Ramesh Nayol (Arch.)
Rorki Raod, Sardulgarh.
12. Whether the building has been constructed for the purpose of school Yes
13. Material used for roofs :
 - a) R.C.C. Slabs Yes
 - b) R.C. joints & Batterns Yes
 - c) Wooden joints & Batterns
 - d) Arch (Brick)
14. Material used for walls :
 - a) Mud Mortar Yes
 - b) Cement Mortar Yes
 - c) Plaster i) Lime Mortar No
ii) Cement Mortar Yes
15. Flooring :
 - a) Conglomerate Yes
 - b) Terracota No
 - c) Brick Paving No
16. A detailed drawing indicating dimensions of the following :
Size and location of doors and windows (Attached)

Signature of the Principal

D.A.V. Public Sen. Sec. School
Khaira Khurd (Sardulgarh)

Part - II
(To be filled in by the S.D.E. of the P.W.D. (B&R) Deptt.)

- a) I have visited the above mentioned school on ...21-5-21... and have virtually examined it from all angles of safety and I find it fit for normal use as a school building.
- b) In case of any addition/alteration or expansion & modification to this building is to be carried out under the supervision of a technically obtained after the completion from the undersigned.
- c) In case of the building in effucted by floor of there is settlement of walls/foundation of sagging or roofs etc. Immediate inspection of the undersigned be arranged to check the stability and safety of the building.
- d) The building can be safely occupied for normal use upto 31st March, 2021
(Year upto which it can be used)
- e) Detailed plan duely countersigned is attached)

*The seg. seems to be safe in
normal conditions of environment*

Ben
21-5-21

Ben
Sub Divisional Engineer,
Provincial Sub Division No. 2,
PWD (B&R) Mansa

EXISTING BUILDING PLAN OF D A V PUBLIC SCHOOL AT KHAIRA RAOD,
VILLAGE KHAIRA KHURD, SARDULGARH, DISTT (MANSA)

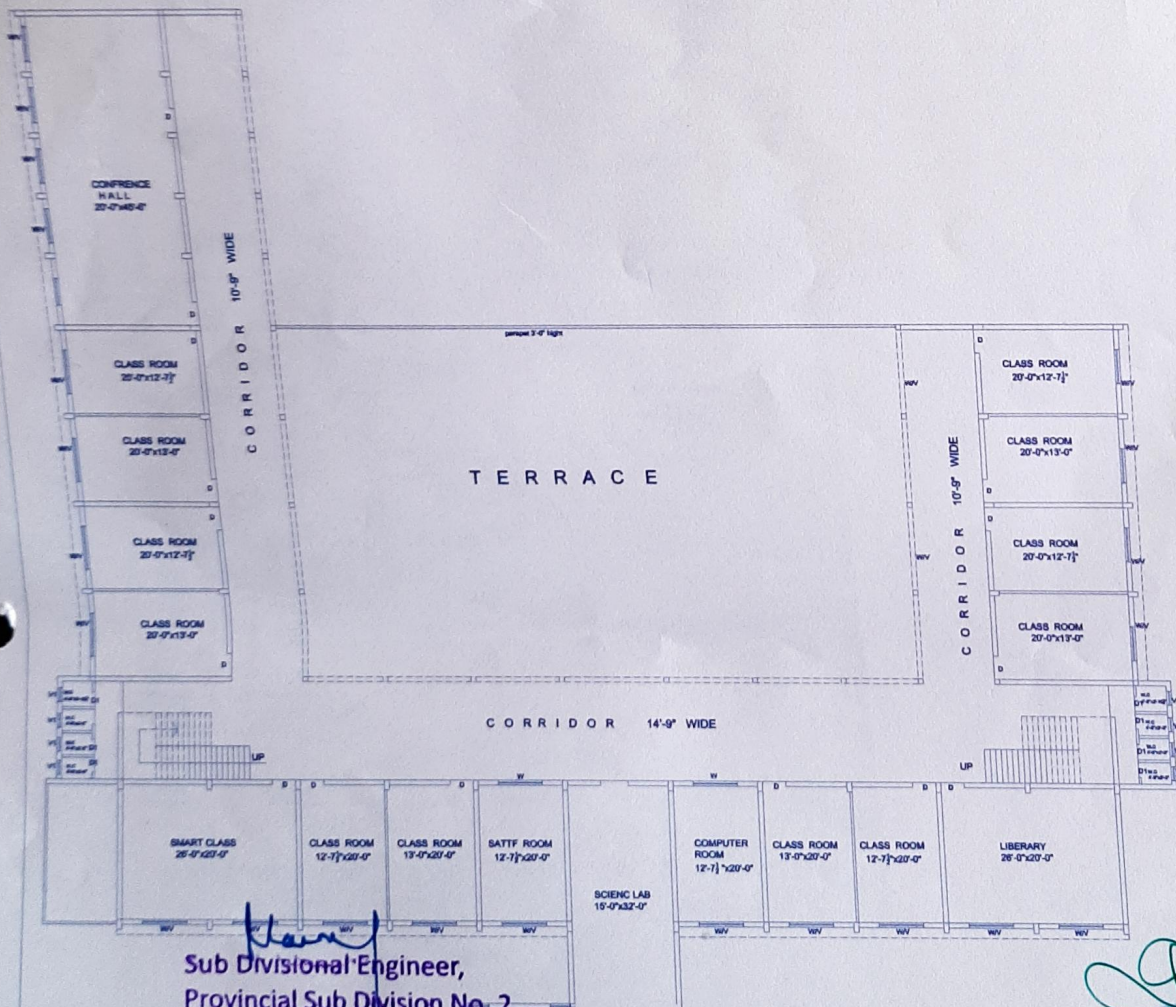

Sub Divisional Engineer,
Provincial Sub Division No. 2
PWD (B&R) Mansa

AREA DETAIL

TOTAL OF PLOT AREA	= 87,120.00 Sq. ft
G.F. COVERED AREA	= 16,491.00 Sq. ft
F.F. COVERED AREA	= 11,317.00 Sq. ft
PLAY GROUND AREA	= 70,629.00 Sq. ft
TOTAL COVERED AREA G.F.+F.F.	= 27,808.00 Sq. ft

JOINERY DETAIL

- D = 4'-0" x 7'-6"
- D1 = 3'-6" x 7'-6"
- D2 = 2'-6" x 7'-6"
- W = 6'-0" x 5'-0"
- V = 3'-0" x 2'-6"

SPECIFICATIONS:-

1. STEPPED FOUNDATION
2. C.CONC. IN DPC.
3. R.C.C. COLUMNS & BEAMS STRUCTURE.
4. MARBLE FLOORING.
5. C.S. PLASTER ON WALLS & CIELING.
6. WOODEN JOINERY.
7. R.C.C. SLAB.
8. TILE TERRACING.

TITLE OF :-

FIRST FLOOR PLAN

SCALE :- 1" = 8'-0"

PRINCIPAL SIGN:-

ARCHITECTS

D.A.V. Public Sen. Sec. School
Khaira Khurd (Sardulgarh)

HOMAX ARCHITECTS
Regn. No. 1490, P.C. Approved
Date 12/2/21
Rorki Road, Sardulgarh
Mansa (Punjab)

EXISTING BUILDING PLAN OF D A V PUBLIC SCHOOL AT KHAIRA ROAD, VILLAGE KHAIRA KHURD, SARDULGARH, DISTT (MANSA)

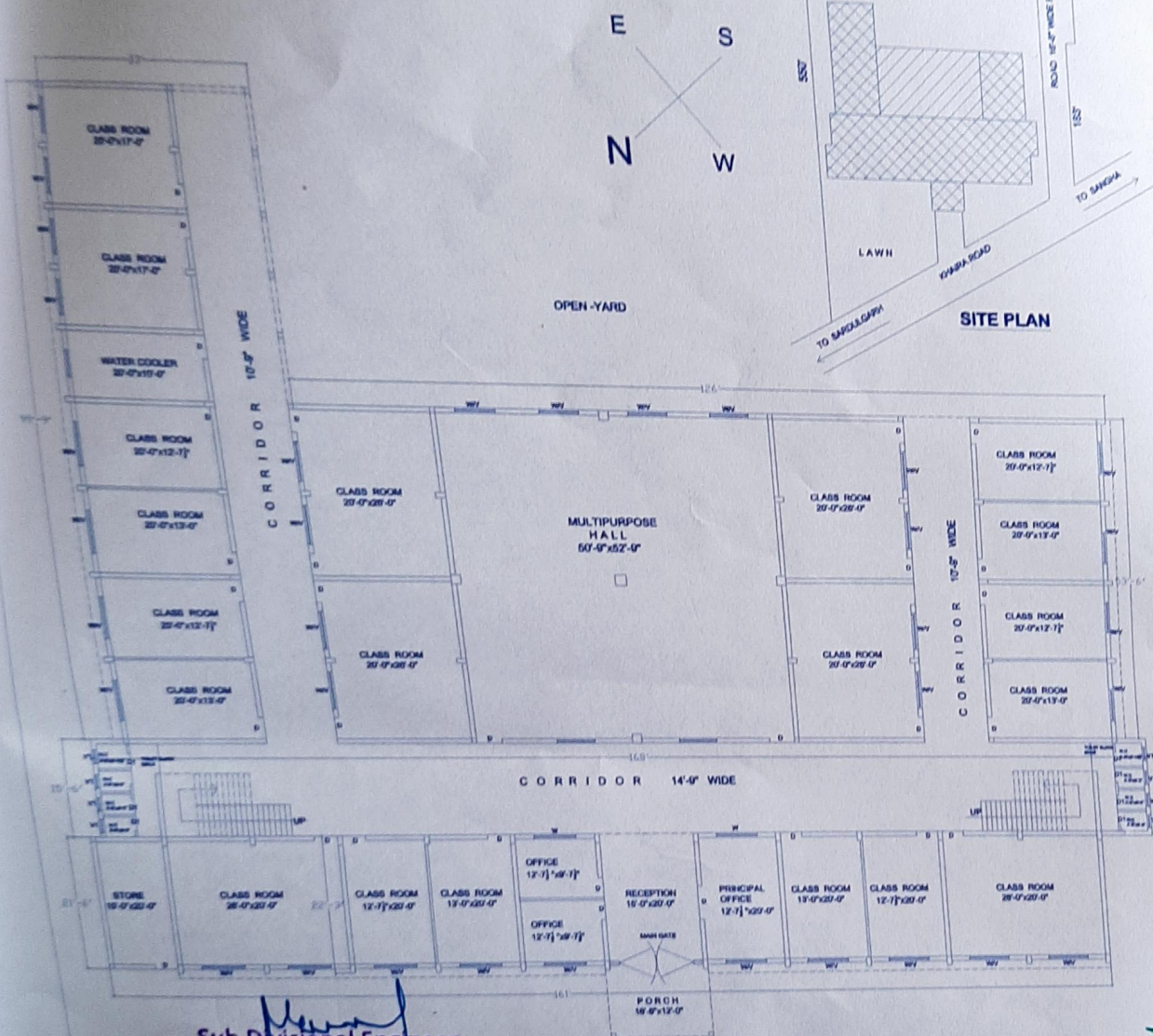

[Signature]
 Sub Divisional Engineer,
 Provincial Sub Division No: 2,
 PWD (B&R) Mansa

AREA DETAIL

TOTAL OF PLOT AREA	= 87,120.00 Sq. ft
G.F. COVERED AREA	= 16,491.00 Sq. ft
F.F. COVERED AREA	= 11,317.00 Sq. ft
PLAY GROUND AREA	= 70,629.00 Sq. ft
TOTAL COVERED AREA G.F.+F.F.	= 27,808.00 Sq. ft

JOINERY DETAIL

- D = 4'-0" x 7'-6"
- D1 = 3'-6" x 7'-6"
- D2 = 2'-6" x 7'-6"
- W = 6'-0" x 5'-0"
- V = 3'-0" x 2'-6"

SPECIFICATIONS:-

1. STEPPED FOUNDATION
2. C.CONC. IN DPC
3. R.C.C. COLUMNS & BEAMS STRUCTURE
4. MARBLE FLOORING.
5. C.S.PLASTER ON WALLS & CIELING
6. WOODEN JOINERY.
7. R.C.C. SLAB.
8. TILE TERRACING

TITLE OF :-

GROUND FLOOR PLAN

SCALE :- 1" = 8'-0"

PRINCIPAL SIGN:-

ARCHITECTS

[Signature]
 Principal
 D.A.V. Public Sen. Sec. School
 Khaira Khurd (Sardulgarh)

HOMAX ARCHITECTS
 Regn No: 1690/M.C Approved
 Date: 12/2/21
 Rorki Road, Sardulgarh
 Mansa (Punjab)